

DOUBLETREE  
BY HILTON™  
WEST EDMONTON

DoubleTree by Hilton West Edmonton  
16615-109th Ave, Edmonton, AB T5P 4K8  
780.930.4017

Room Name	Total Sq. Ft	Dimensions	5' Rounds (8 per table)	6' Rounds (12 per table)	Reception	Classroom	Theatre	Boardroom	U-Shape	H-Square
Grand Ballroom	8,422	126' x 67' x 16.5'	568	672	800	480	1000	-	-	-
Ballroom 1	1,541	23' x 67' x 13'	112	120	160	90	180	54	50	60
Ballroom 2	1,809	23' x 67' x 13'	120	132	180	110	200	54	50	60
Ballroom 3	1,809	23' x 67' x 13'	120	132	180	110	200	54	50	60
Ballroom 4	3,283	49' x 67' x 16.5'	216	288	300	144	360	54	74	90
Ballroom 1 & 2	3,350	50 x 67' x 13'	232	252	300	180	380	54	74	90
Ballroom 1, 2 & 3	5,159	77' x 67' x 13'	272	384	500	280	580	-	-	-
Ballroom 2 & 3	3,618	54' x 67' x 13'	240	264	350	220	400	-	-	-
Ballroom 2, 3 & 4	6,901	103' x 67' x 16.5'	456	552	660	360	760	-	-	-
Ballroom 3 & 4	5,092	76' x 67' x 16.5'	336	420	480	240	560	-	-	-
Alpine Lakes Room	2,750	96.5' x 28.5' x 10'	160	192	240	128	240	-	-	-
Maligne	713	28.5' x 25' x 10'	40	48	50	32	50	24	22	28
Morraine	698	28.5' x 24.5' x 10'	40	48	50	32	50	24	22	28
Amethyst	684	28.5' x 24.5' x 10'	40	48	50	32	50	24	22	28
Emerald	656	28.5' x 23' x 10'	40	48	50	32	50	24	22	28
2 Adjoining	1,539	57' x 27' x 10'	80	96	120	64	100	40	40	48
3 Adjoining	2,308	85.5' x 27' x 10'	120	144	180	68	150	-	-	-
SilverBirch Conference Centre Rooms										
SBCC #1 (TBC)	430	31' x 15' x 9.5'	-	-	-	-	-	20	-	-
SBCC #1 (TBC)	460	28' x 22' x 9.5'	-	-	-	18	-	-	-	-
SBCC #3	660	40' x 21' x 9.5'	-	-	-	-	-	-	-	30
SBCC #4	630	25' x 19' x 9.5'	-	-	-	-	-	-	12	-
SBCC #5 (Video Conference)	720	48' x 30' x 9.5'	-	-	-	40	-	-	-	-
SBCC #6	830	37' x 24' x 9.5'	-	-	-	-	-	-	-	30
SBCC #7	1,450	68' x 34' x 9.5'	-	-	-	60	-	-	-	-



DoubleTree by Hilton West Edmonton  
16615-109th Ave, Edmonton, AB T5P 4K8  
780.930.4017

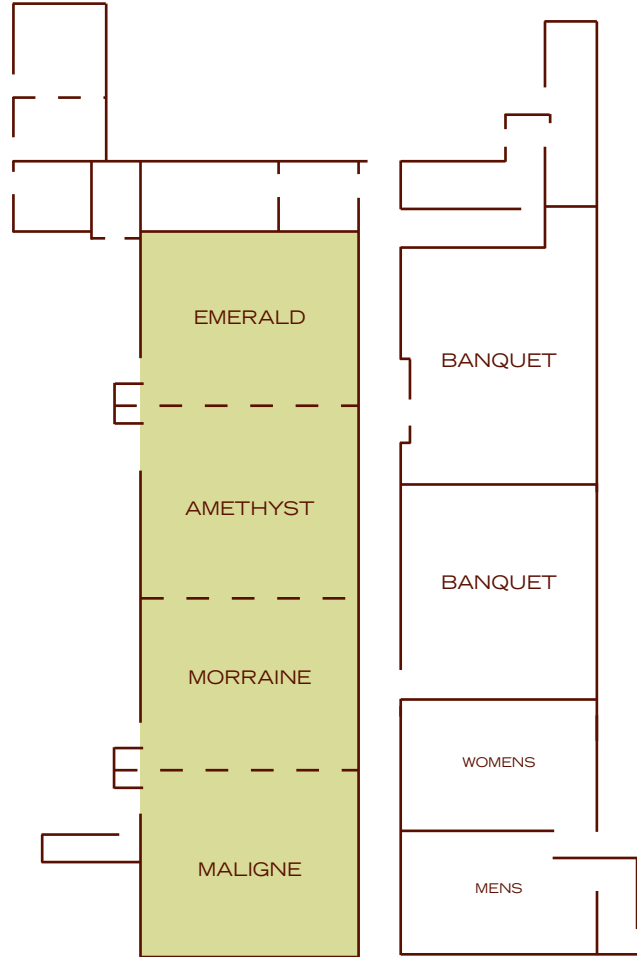
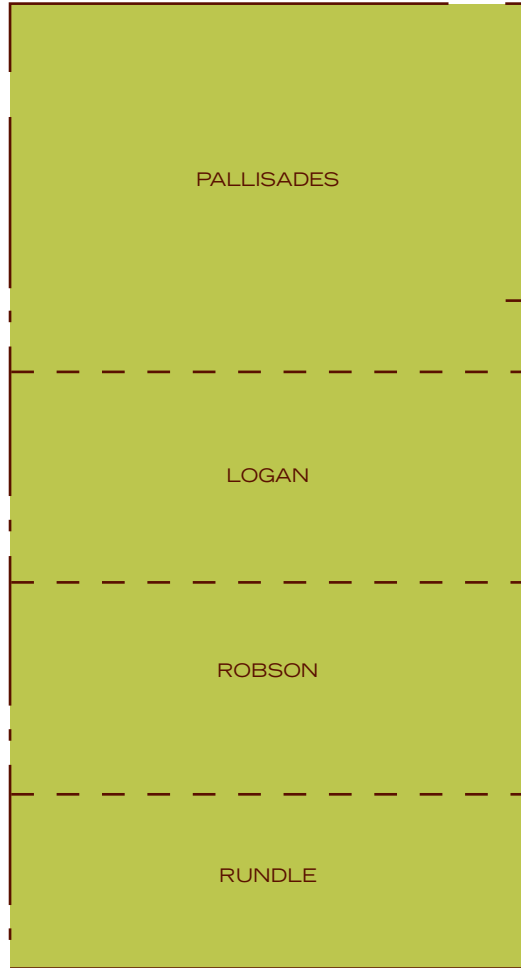

**DOUBLETREE**  
 BY HILTON™  
 WEST EDMONTON

DoubleTree by Hilton West Edmonton  
 16615-109th Ave, Edmonton, AB T5P 4K8  
 780.930.4017